



多层注塑技术助力一次性咖啡胶囊项目

System Development

May-17-2021

HUSKY

Keeping our customers in the lead

市场验证的多层技术



10 applications
 58 machines since 2015
 in 13 countries @ 24 customers



Innovation Award 2018

Manuel Jorge

多层技术的应用

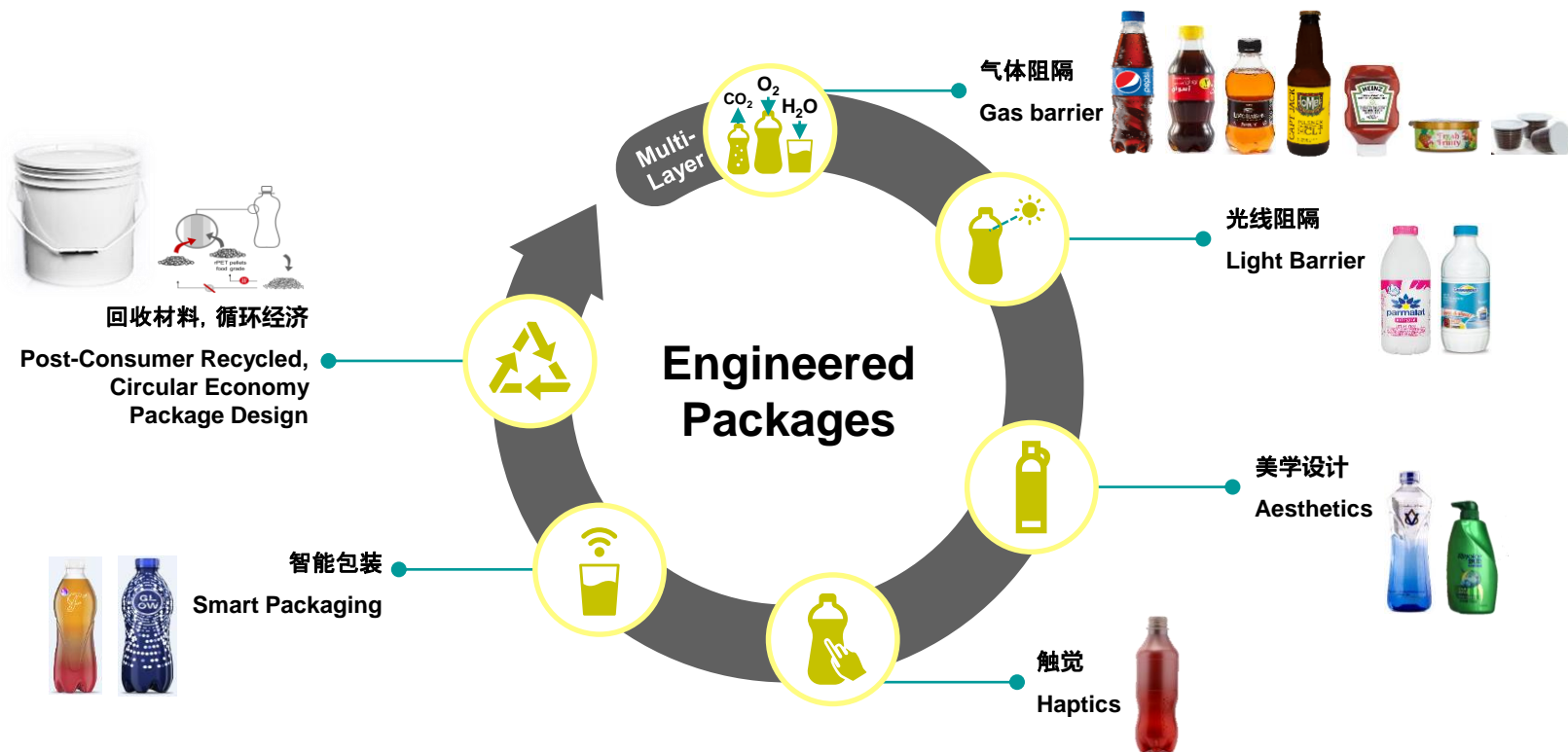

多层技术创新-智能包装

‘荧光’
夜光



- 12oz (355ml) CSD bottle
- 26 / 22 neck, 15.6g
- nylon + fluorescence + UV brightener

热敏性
‘颜色随着温度变化’



- 12oz (355ml) CSD bottle
- 26 / 22 neck, 15.6g
- thermochromic additive

‘颜色渐变’的
美学效果



- 12oz (355ml) inverted CSD bottle
- PCO1881 + over-cap, 17g



多层技术应用于回收料使用

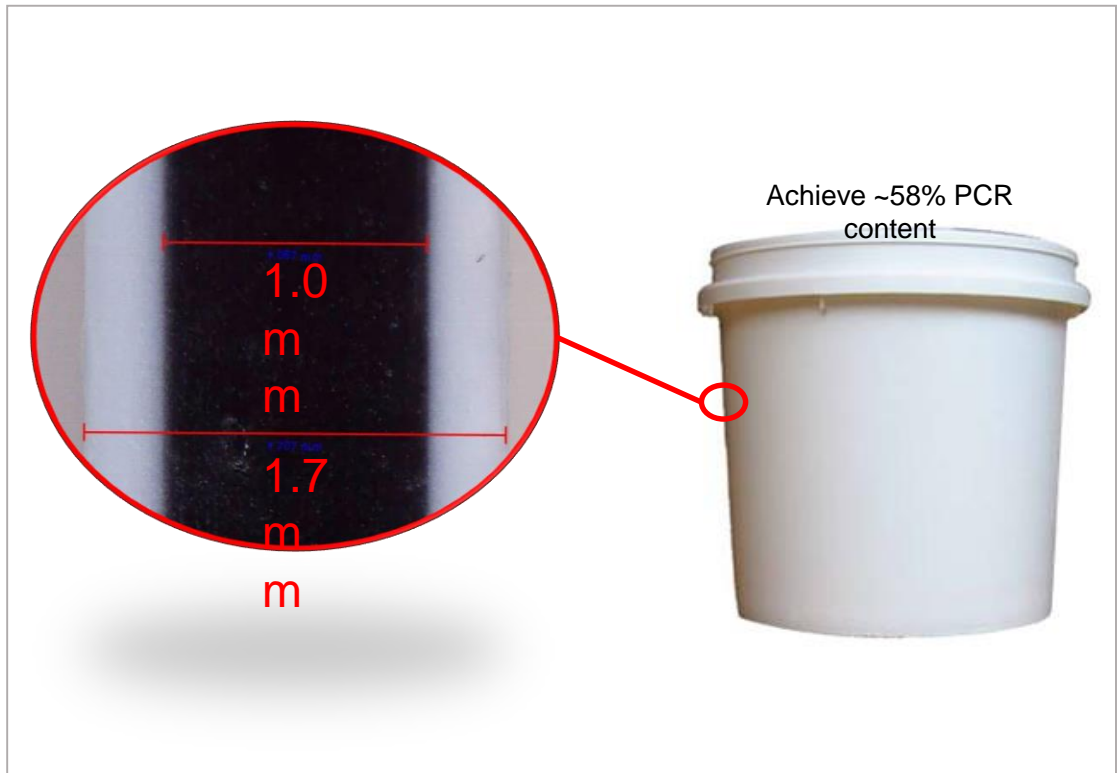
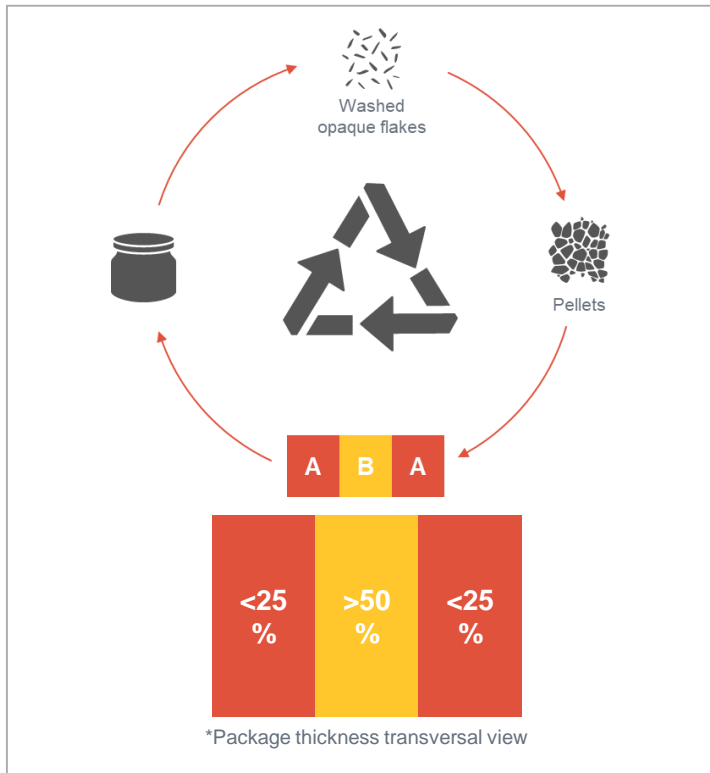

一次性胶囊市场经验

- **40+** 咖啡胶囊项目
 - 高达 72 cav
 - 单层和多层系统
 - 重量: 1.4 to 6.0 g
 - 壁厚范围: 0.3 - 1.0 mm
- 材料: PP, PBT, PLA
- 阻隔剂: EVOH, PVOH

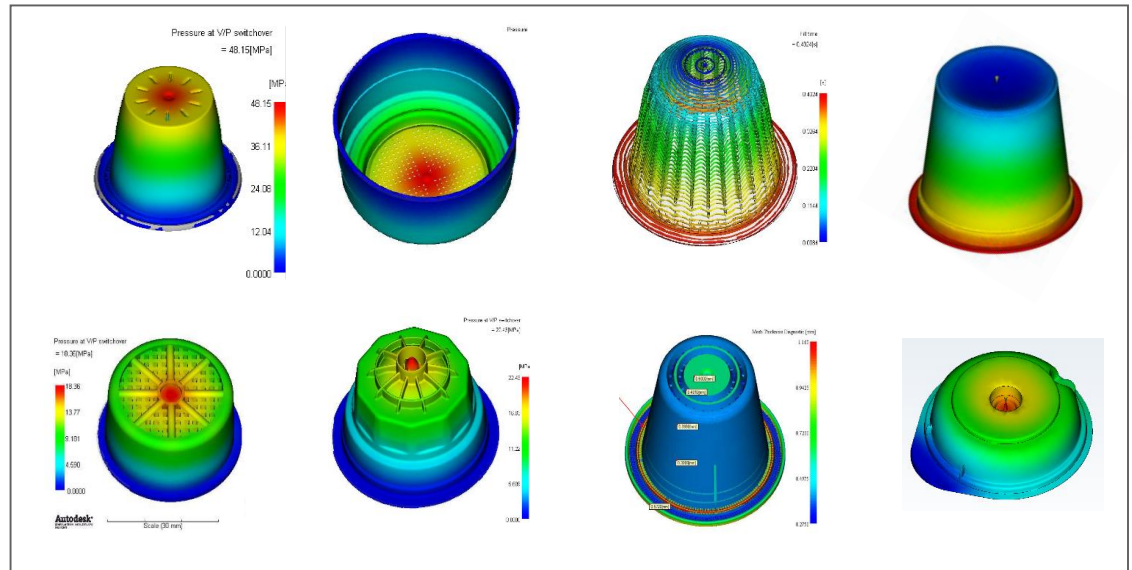

Manuel Jorge

行业中最最好的多层注塑技术

40%的产量高于行业中其他的多层注塑技术

Capability **40 %** higher compared to other co-injection multi-layer alternatives

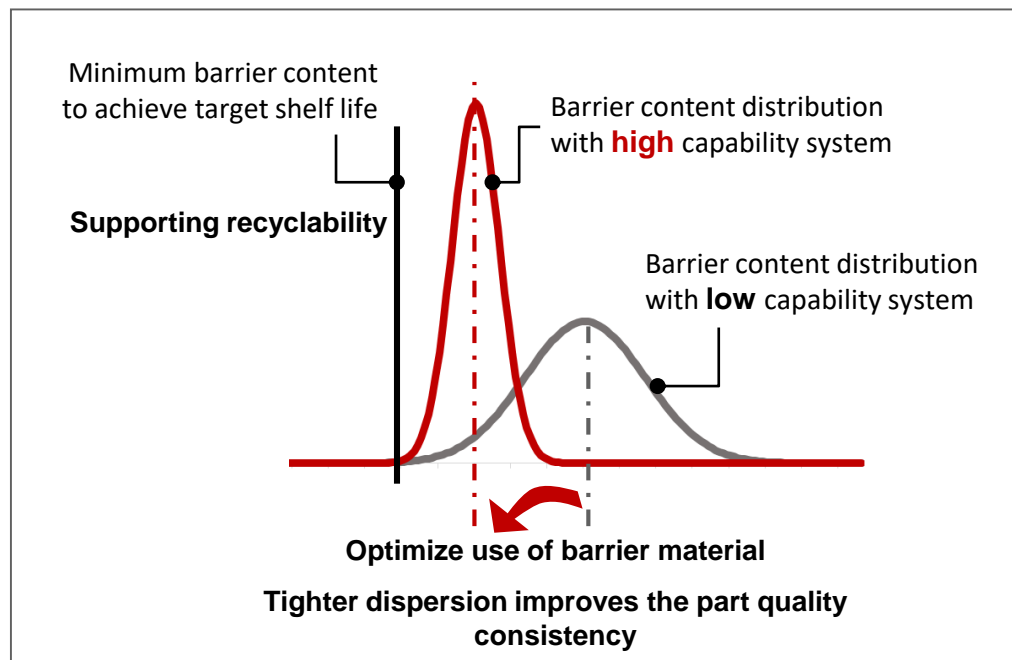

更好的技术支撑更好的产品包装保护

Better technology gives you better package protection!

多层包装的关键属性

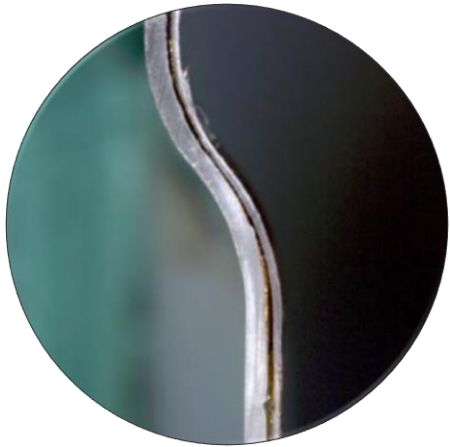

阻隔层的均匀性
UNIFORMITY



阻隔层的精确性
ACCURACY



阻隔层的封闭性
ENCAPSULATION



阻隔包装注塑系统的解决方案

Robust & Precise Mold
精密模具

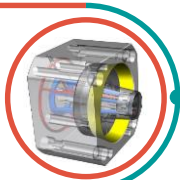

**Servo Actuated
Valve Gate Stems**
伺服驱动阀针系统



**Balanced Melt
Distribution HR**
超精密的热流道平衡性

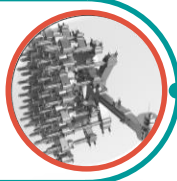

**Servo Actuated
Barrier Injection Unit**
伺服驱动注塑单元

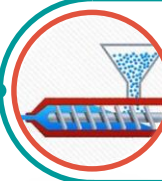

**Symmetrical
Flow Nozzle**
同步注塑喷嘴



**Full Integrated
System Controls**
整合的系统控制

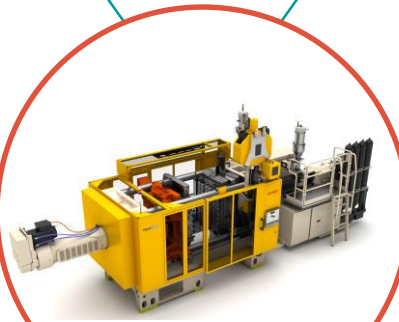

任何单一部件都会影响到阻隔层成型

阻隔层的厚度变化

**只有几微米的厚度差异，
提供完美的阻隔层保护**

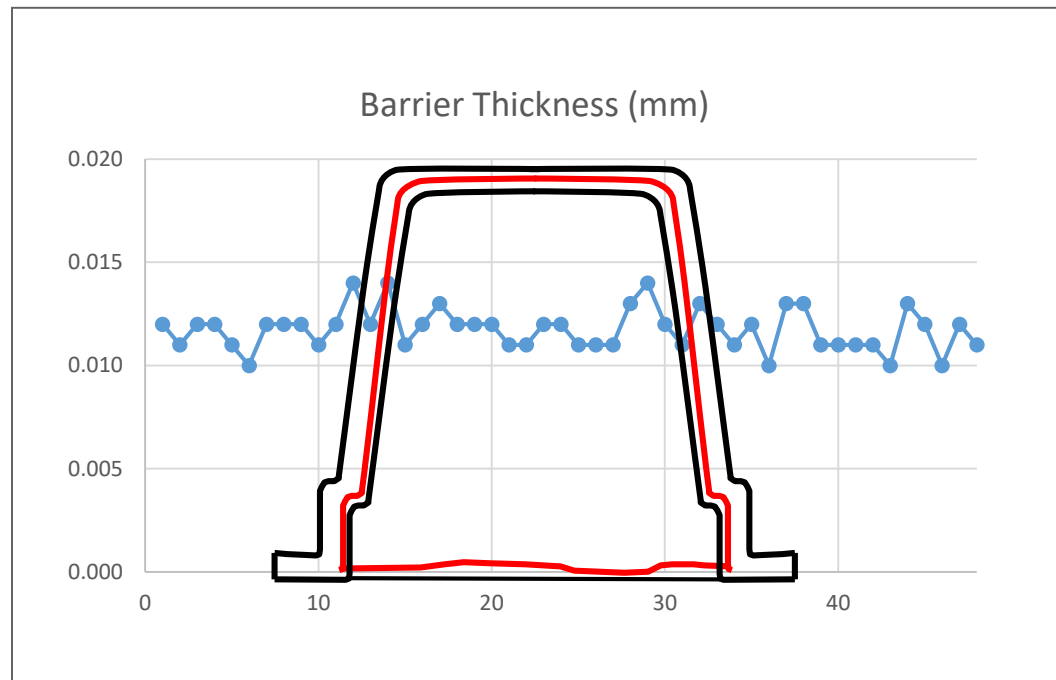
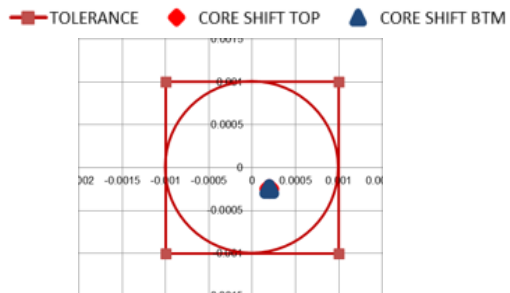

完全的阻隔成型保证产品的完整保护

透氧率Oxygen Transmission Rate

OTR – PP/EVOH/PP



0.00055 cm³/pkg.day
0.084 cm³/m².day

15 µm barrier layer thickness

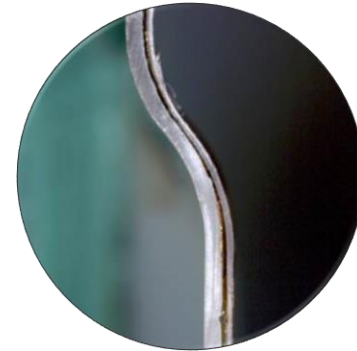

新一代注塑系统助力于增加产量

HyperSync™

Up to **20% faster** cycle time
versus competitors for similar
part geometry

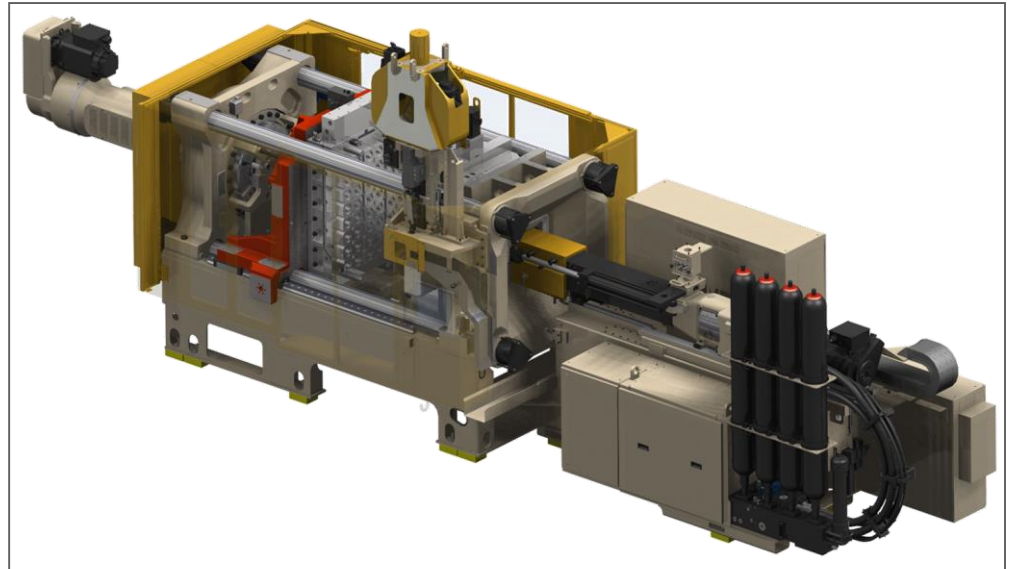

咖啡胶囊多层注塑项目一览



HUSKY核心价值

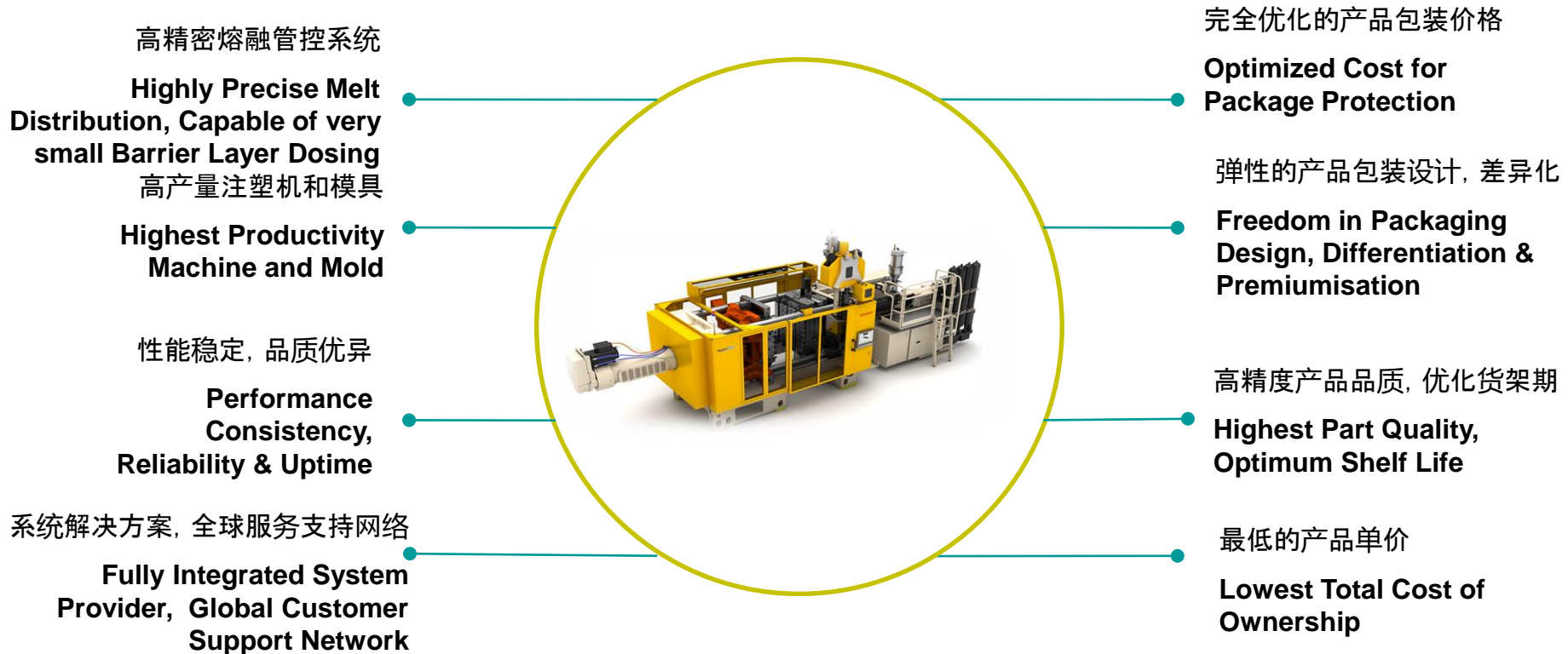



多层注塑技术助力一次性咖啡胶囊项目

System Development

May-17-2021

HUSKY

Keeping our customers in the lead